

ARDEN & WAY

BLOCK MANAGEMENT & LETTINGS



1 Winsor Close

, Hayling Island, PO11 9RF

£147,000

Arden & Way are delighted to present to the sales market this excellent investment opportunity — a ground floor, two double bedroom flat situated in a quiet cul-de-sac. The property offers an attractive gross yield of 8.4% and an estimated net yield of 7.87%, making it an appealing addition for investors looking to grow their portfolio.

The property is located in a convenient coastal area, within easy reach of a range of local amenities. Havant Town Centre, with its mainline train service to London, is approximately a twenty-minute drive away. The property is offered with NO ONWARD CHAIN, allowing for a straightforward and potentially quick purchase.

Internally, this well-presented and surprisingly spacious ground floor flat offers a generously sized open plan living room/kitchen. An inner hallway leads to two good sized double bedrooms and a bathroom fitted with a bath and overhead shower.

Externally, the building benefits from communal gardens to the front and residents parking available in the road.

This property represents a strong coastal investment opportunity with solid rental returns.

For more information or to arrange a viewing, please contact Arden & Way.

Viewing

Please contact our Arden & Way Office on 02392 460 899 if you wish to arrange a viewing appointment for this property or require further information.



Floor Plan

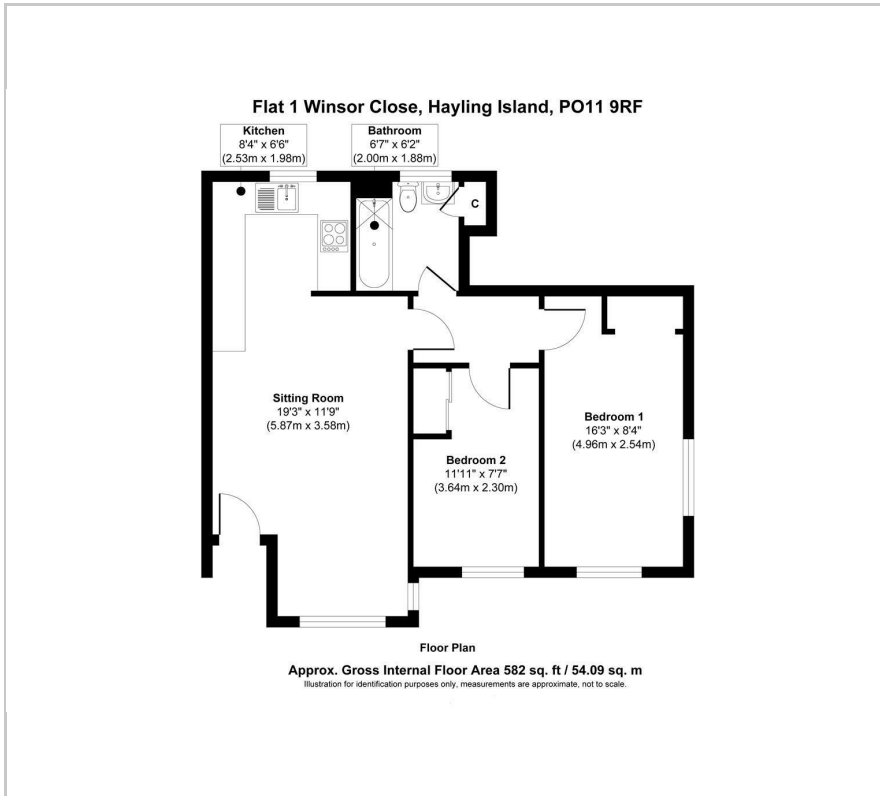

Area Map

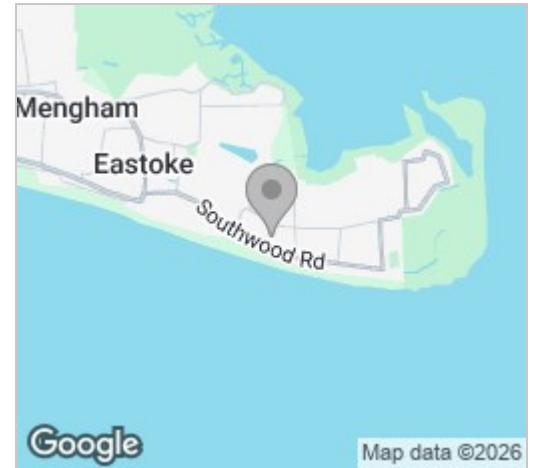

Energy Efficiency Graph

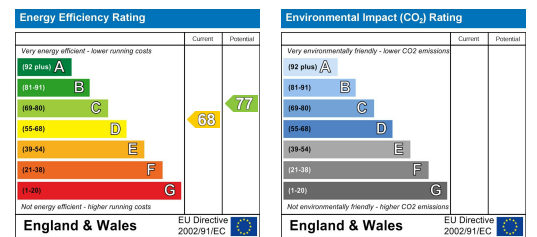

These particulars, whilst believed to be accurate are set out as a general outline only for guidance and do not constitute any part of an offer or contract. Intending purchasers should not rely on them as statements of representation of fact, but must satisfy themselves by inspection or otherwise as to their accuracy. No person in this firm's employment has the authority to make or give any representation or warranty in respect of the property.

120 Elm Grove, Hayling Island, Hampshire, PO11 9EH

Tel: 02392 460 899

Email: info@ardenway.co.uk

www.ardenway.co.uk